

| Câmara Cold Room | | Dimensões / Dimensions (mm) | | | Peso Bruto Gross weight (Kg) |
|---------------------|----------|-----------------------------|------------------------|---------------------|------------------------------------|
| | | Interiores Internal | Exteriores External | Embalagem / Package | |
| SMART | ECO | 1200 x 1500 x 1950 | 1360 x 1660 x 2070 | 800x1580x2200 | 254 |
| 10701003 | 10701203 | | 1400 x 1700 x 2110 | 1000x1580x2200 | 276 |
| 10702003 | 10702203 | | 1440 x 1740 x 2150 | | 295 |
| 10703003 | 10703203 | 1200 x 1500 x 2300 | 1360 x 1660 x 2420 | 800x1580x2420 | 284 |
| 10704003 | 10704203 | | 1400 x 1700 x 2460 | 1000x1580x2420 | 312 |
| 10705003 | 10705203 | | 1440 x 1740 x 2500 | | 331 |
| 10706003 | 10706203 | | | | |

ESQUEMA DE MONTAGEM BASE / Standard Assembly Scheme

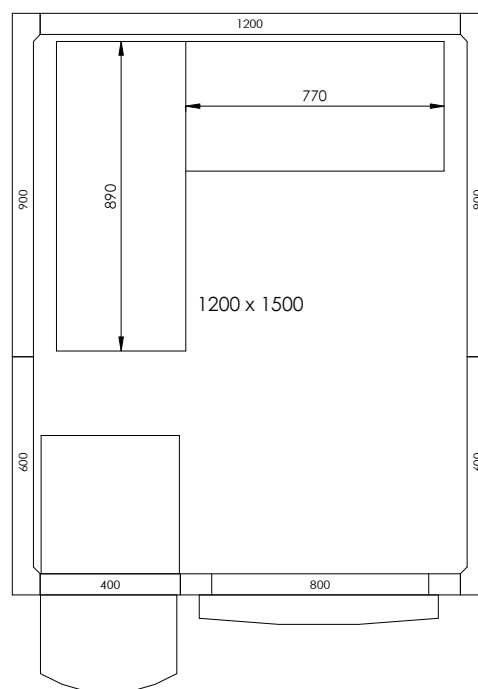

| Grupo Cooling unit | | Dimensões Embalagem Dimensions Package (mm) | Peso Bruto Gross Weight (Kg) | Estanteria Shelving | Dimensões Embalagem Dimensions package (mm) | Peso Bruto Gross Weight (Kg) |
|-----------------------|----------|---|------------------------------------|------------------------|---|------------------------------------|
| SMART | ECO | | | | | |
| 10801001 | 10801201 | 670 x 920 x 2100 | 91 | 00901002 | 1700 x 425 x 300 | 18,60 |
| 10802001 | 10802201 | | 92 | | | |
| 10802007 | 10802207 | | 95 | | | |
| 10803001 | 10803201 | | 96 | | | |
| 10804001 | 10804201 | 670 x 920 x 2450 | 93 | | | |
| 10805001 | 10805201 | | 94 | | | |
| 10805007 | 10805207 | | 97 | | | |
| 10806001 | 10806201 | | 98 | | | |

ESQUEMA DE MONTAGEM ALTERNATIVO / *Alternative Assembly Scheme*

